

DEEP TILLAGE CAST RIPPER LEG REPLACEMENT ACCESSORIES

(To suit all TIAPAG & KAG assemblies and shanks)

TIAPAG001
24" Ripper Leg Shank



TIAPAG030
30" Ripper Leg Shank

TIAPAG003
Standard Point

TIAPAG003-TG
Extra Heavy Duty Point with large Tungsten Tile + extra Ag-Tuff

TIAPAG003T-TG
Point with tungsten tile & Ag-Tuff/Keetuff on nose.



TIAPAG013 4" x 4"
Toolbar Clamp Plate



TIAPAG012 4" x 4"
Toolbar Bracket

TIAPAG015
Shin Guard Standard



TIATIL015
Tilco Style Shin Guard Bottom UNPAINTED
Suit Tilco Style Shanks



TIATIL003
Tilco Style Point UNPAINTED BLANK
Suit Tilco Style Shanks

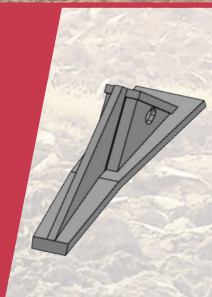

TIATIL003-AT
Tilco Style Point With Grit
Suit Tilco Style Shanks

YEOMANS WOMBAT POINTS

TIAWOM-003-AT
Yeomans Wombat point with Tungsten tile and Ag-Tuff

TIAWOM-003
Yeomans Wombat plain point with Tungsten tile only



KAG008
L/H adaptor for Mulch Blade assembly

KAG009
R/H adaptor for Mulch Blade assembly

PT116
Mulch Blade to 16" (2)

KAG110
Full Mulch Blade assembly



SHEAR PINS & CLIPS

SP061

Standard Shear pin Replaces GWT-GWSP061, Gessner 025-063, Agroplow 141-0016.

SP071

Replaces Agroplow 141-4011

SP095

Replaces Agroplow 141-0061

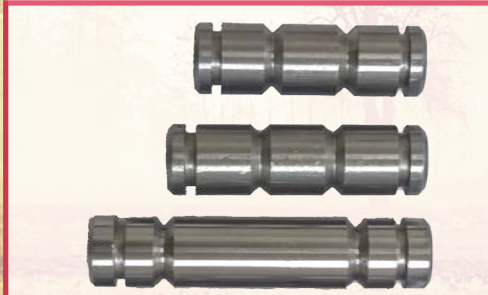

MISCELLANEOUS

AG0083-513-AT

Clydesdale Mini Ripper Point with AgTuff.

AG0083-513

Clydesdale Mini Ripper Point.



"NEW"

HSP061 Shear pin

Suits Tilco style shanks, or 32mm wide shanks.



Bendigo
Unit 2, 204 Strickland Rd,
Bendigo East, Vic 3500
FreeCall: 1800 087 871
Phone: (03) 5449 3499
Fax: (03) 5449 3266
bendigo@agpoint.com.au

Freeling
3 Borrow Street,
Freeling SA 5372
FreeCall: 1800 088 538
Phone: (08) 8525 3500
FreeFax: 1800 802 394
sales@agpoint.com.au

Toowoomba
74-92 Buckland Street,
Toowoomba, QLD 4350
FreeCall: 1800 087 871
Phone: (07) 4591 3300
Fax: (07) 4591 3350
twmba@agpoint.com.au



CAST RIPPER LEG ASSEMBLIES & COMPONENTS



DEEP TILLAGE CAST RIPPER LEG ASSEMBLIES: EXTRA HEAVY DUTY

Suits 6" x 6" or 7" x 7" Square RHS frames.
28" to 32" underframe options.

AG7014-019: 28" to 32"

Under frame adjustable assembly supplied with Shank AG7008-016, Shank Depth Adjuster AG7012-067 & Toolbar bracket AG7012-102 to suit 7" x 7" Bar. Includes all hardware, shear pin, Tungsten point & shin guard.



AG7014-045: 28" to 32" Heavy Duty

Under frame adjustable assembly supplied with Shank AG7008-016, HD Shank Depth Adjuster AG7012-239 & Toolbar bracket AG7012-102 to suit 7" x 7" Bar. Includes all hardware, shear pin, Tungsten point & shin guard.

AG7014-044

Adjustable assembly to suit 6" x 6" Bar.

AG7014-018

Adjustable assembly to suit 6" x 6" Bar.

AG7014-021

Fixed assembly to suit 6" x 6" Bar.

AG7014-020: 28"

Under frame fixed assembly supplied with Shank AG7008-009 & Toolbar bracket AG7012-102 to suit 7" x 7" Bar. Includes all hardware, shear pin, Tungsten point & shin guard.



EXTRA HEAVY DUTY DEEP TILLAGE CAST RIPPER LEG REPLACEMENT ACCESSORIES

(To suit all AG7014 series assemblies)

AG7008-016: Shank

Shank leg to suit AG7014-019, AG7014-045, AG7014-018 & AG7014-044 Assemblies.



AG7008-009: Fixed Shank Leg

Fixed Shank leg to suit AG7014-020 & AG 7014-021 Assemblies.



AG7012-067: Depth Adjuster

Shank depth adjuster to suit AG7014-019 & AG7014-018 Assemblies.



AG7012-239: HD Depth Adjuster

Heavy Duty shank depth adjuster to suit AG7014-045 & AG7014-044 Assemblies.



AG7012-102: 7" x 7" Mounting Bracket Assembly

Toolbar bracket suit AG7014-019, AG7014-020 & AG7014-045 Assemblies.



AG7012-103: 6" x 6" Mounting Bracket Assembly

Toolbar bracket suit AG7014-018, AG7014-044 & AG7014-021 Assemblies.



AG7004-026-AT: Point

Point with Ag-Tuff on the nose & along the gills. Supplied with all new assemblies.



AG7004-025 Plain Point

(not shown) with no wear enhancement.

AG7003-031: Shin Guard

Shin guard to suit all AG7014 assemblies.



DEEP TILLAGE CAST RIPPER LEG ASSEMBLIES

Suits 4" x 4" Square RHS Frames
Available with either 24"
or optional 30" underframe legs.

This cast ripper leg has stood the test of time over the decades and is used by Original Equipment Manufacturers across Australia.

Made from high tensile steel this rigid cast ripper leg assembly is also shear pin protected.

The assembly comes fitted with a replaceable shin guard and standard point.

The assembly has many point options available with various levels of tungsten grit (Ag-Tuff) as well as various tungsten tile options.

As an optional extra a 16" mulch blade assembly is available.

TIAPAG024: 24"

Assembly is supplied fully assembled and includes all hardware, standard point and shin guard. (Shown left with Mulch blade assembly)

TIAPAG031: 30"

Assembly is supplied fully assembled and includes all hardware, standard point and shin guard. (Shown right)

